

Rubber Fab Technologies Group's

SANITARY TRI-CLAMP FITTINGS

SIZING GUIDE

These actual size drawings are provided to eliminate sizing errors when specifying sanitary fittings. The outside diameter is the same for 1/8", 1/4", 3/8", 1/2" and 3/4" I.D., "mini" styles. The same holds true for the 1" and 1-1/2" I.D. sizes (1.984" O.D.).

The 2", 2-1/2" and 3" I.D. have specific O.D. diameters.

For your convenience and ordering accuracy, all of these drawings may be used as sizing, I.D. and O.D. patterns.

For 4" (not pictured) ID: 3.75 OD: 4.675

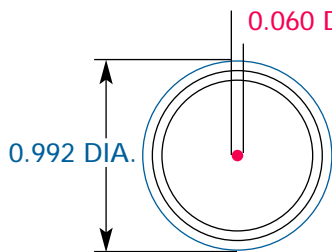

1/8" MINI TC

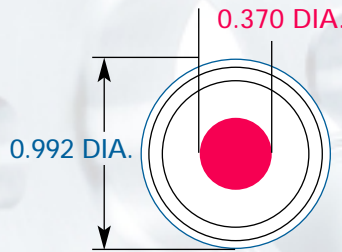

1/2" MINI TC

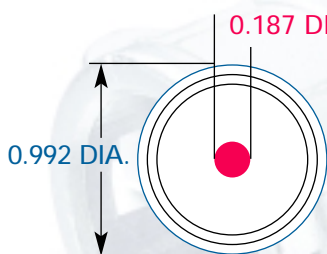

1/4" MINI TC

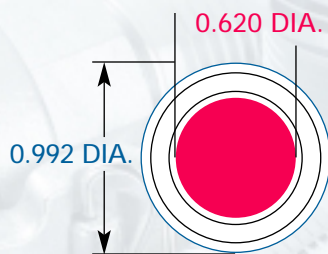

3/4" MINI TC

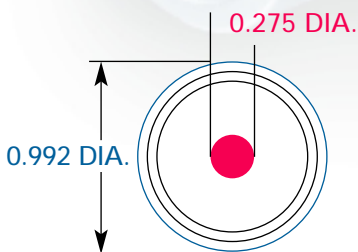

3/8" MINI TC

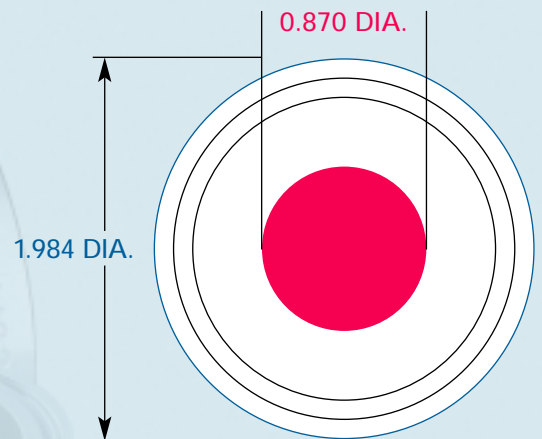

1" LADISH® TC

NOTE:

I.D. measurements are indicated in red;

O.D. measurements are indicated in blue

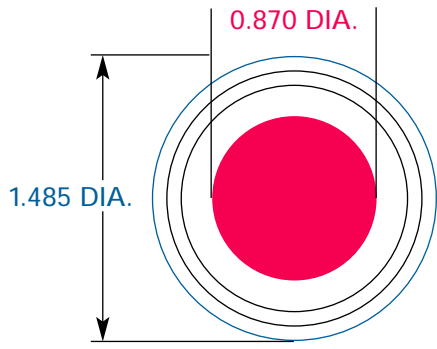

1" MAXITC

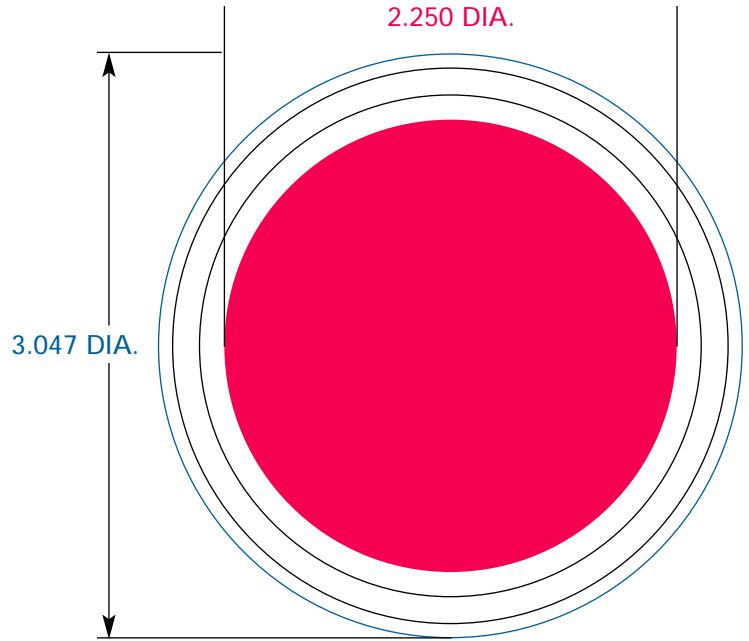

2-1/2" TC

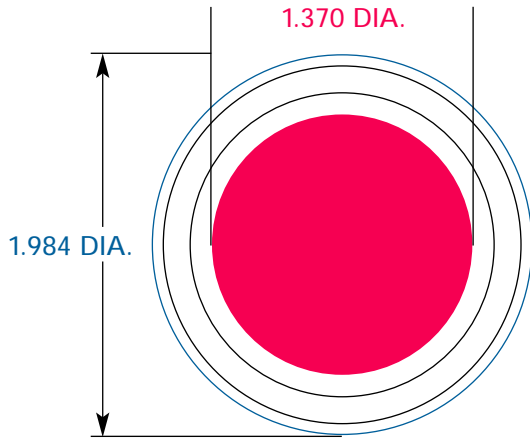

1-1/2" TC

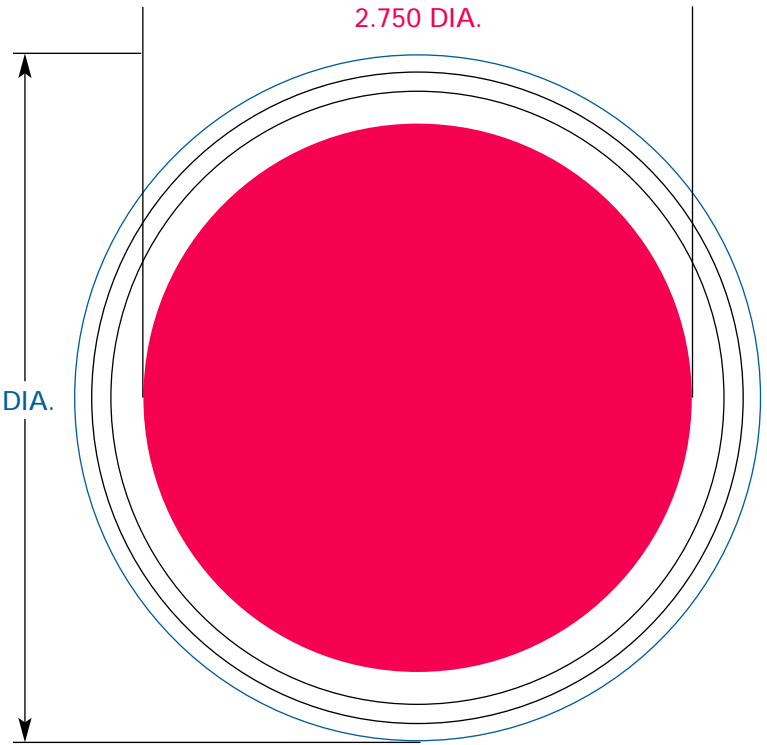

3" TC

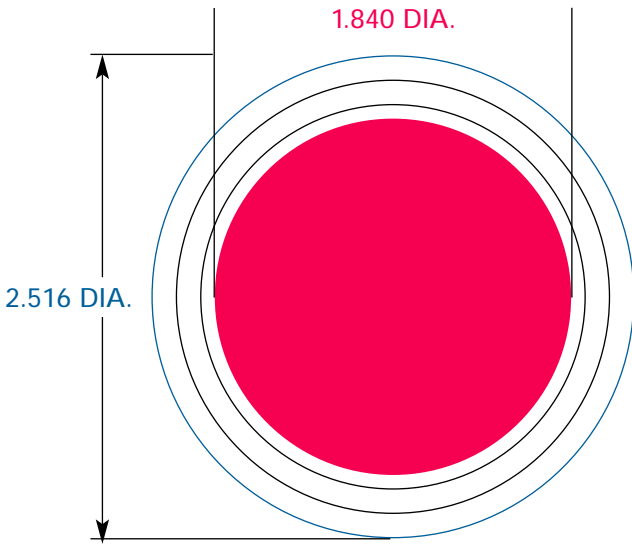

2" TC

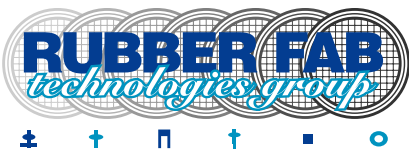

Rubber Fab Technologies Group
Limecrest Road

P.O. Box 626 • Andover, NJ 07821
phone: 973-579-2959 fax: 973-579-7275
www.rubberfab.com

Rubber Fab Technologies Group is a member of:



Distributed by:

Tri-Clamp® is a registered trademark of Ladish Company
Ladish® is a registered trademark of Ladish Company